

LEAD-BASED PAINT INSPECTION

for

**PIKE COUNTY HOUSING AUTHORITY
PERRY UNITS
PERRY, ILLINOIS**

date of sampling:

MAY 10 & 17, 2013

table of contents:

- ① INTRODUCTION
- ② SUMMARY OF FINDINGS (POSITIVE MATERIALS)
- ③ XRF ANALYSIS SUMMARY
- ④ SITE PLAN(S)
- ⑤ INSPECTOR'S CREDENTIALS
RADIOACTIVE MATERIAL LICENSE

consultant:

**HINDS ENVIRONMENTAL, INC.
2975 STANTON STREET
SPRINGFIELD, ILLINOIS 62703
(217) 585-8970 • FAX (217) 585-8879**

SECTION 1

INTRODUCTION

A. APPLICABLE STANDARDS

This inspection report was developed in accordance with HUD/EPA standards for lead-based paint of 1.0 mg/cm^2 or 0.5% by weight as defined by Title X of the 1992 Housing and Community Development Act. Title X is also known as the Residential Lead-based Paint Hazard Reduction Act of 1992.

B. PROTOCOL

INSPECTION PROTOCOL

The intent of this lead-based paint inspection was to inspect and identify lead-based paint on building component surfaces both on the interior and the exterior.

SAMPLING PROTOCOL

Lead-based paint sampling is done using a Niton XLp Spectrum Lead Detector (Model 300A) X-ray Fluorescence (XRF) instrument. This device uses a radioactive source that releases photons of energy onto a painted surface. The emitted photon causes a characteristic wavelength of energy to be released. The instrument then measures the energy release to determine if lead is present and at what amount. Substrate correction is not necessary with this instrument, and it can penetrate 20 layers of paint.

The lead summary of findings identifies building components that tested positive for lead-based paint. The XRF analysis sheets have identified testing areas. The sheets have reading number, then list component tested, substrate, side, condition, color, room, unit number and result. (Color listed is the visible color and may not be the color of the paint that contains lead.) No device at present can differentiate what layer or layers of paint on a surface actually is/are the layer or layers that contain lead. The results are reported as positive or negative in comparison to the standard of 1.0 mg/cm^2 . A negative result does not necessarily mean that no lead is present in the paint, but that the amount of lead in the paint is less than 1.0 mg/cm^2 .

SECTION 2

**LEAD SUMMARY OF FINDINGS
(POSITIVE MATERIALS)**

**PIKE COUNTY HOUSING AUTHORITY
PERRY UNITS
PERRY, ILLINOIS**

INTERIOR

PAINTED WOOD DOOR STOPS
PAINTED WOOD WINDOW CASINGS
PAINTED WOOD DOOR CASINGS

EXTERIOR

ORIGINAL PAINTED WOOD COMPONENTS UNDER STEEL TRIM AND VINYL

SECTION 3

PIKE COUNTY HOUSING AUTHORITY
PERRY

Reading #	Component	Substrate	Side	Condition	Color	Room	Unit #	Results	PbC
1	Self Calibrate								6.06
2	Calibrate								1
3	Calibrate								1.1
4	Calibrate								1
5	Wall	Gypsum	A	Intact	Ivory	Living Room	5	Negative	< LOD
6	Wall	Gypsum	B	Intact	Ivory	Living Room	5	Negative	< LOD
7	Wall	Gypsum	C	Intact	Ivory	Living Room	5	Negative	< LOD
8	Wall	Gypsum	D	Intact	Ivory	Living Room	5	Negative	< LOD
9	Ceiling	Gypsum	-	Intact	Ivory	Living Room	5	Negative	< LOD
10	Door	Metal	A	Intact	Ivory	Living Room	5	Negative	< LOD
11	Door Casing	Metal	A	Intact	Ivory	Living Room	5	Negative	< LOD
12	Window Casing	Metal	B	Intact	Ivory	Living Room	5	Negative	< LOD
13	Window Sash	Metal	B	Intact	White	Living Room	5	Negative	< LOD
14	Window Infill	Wood	B	Intact	Ivory	Living Room	5	Negative	< LOD
15	Wall	Gypsum	A	Intact	Ivory	Utility Closet	5	Negative	< LOD
16	Wall	Gypsum	B	Intact	Ivory	Utility Closet	5	Negative	< LOD
17	Wall	Gypsum	C	Intact	Ivory	Utility Closet	5	Negative	< LOD
18	Wall	Gypsum	D	Intact	Ivory	Utility Closet	5	Negative	< LOD
19	Ceiling	Gypsum	-	Intact	Ivory	Utility Closet	5	Negative	< LOD
20	Attic Access	Wood	-	Intact	Ivory	Utility Closet	5	Negative	< LOD
21	Shelf	Metal	A	Intact	Ivory	Utility Closet	5	Negative	< LOD
22	Wall	Gypsum	A	Intact	Ivory	Kitchen	5	Negative	< LOD
23	Wall	Gypsum	B	Intact	Ivory	Kitchen	5	Negative	< LOD
24	Wall	Gypsum	C	Intact	Ivory	Kitchen	5	Negative	< LOD
25	Wall	Gypsum	D	Intact	Ivory	Kitchen	5	Negative	< LOD
26	Ceiling	Gypsum	-	Intact	Ivory	Kitchen	5	Negative	< LOD
27	Door	Metal	C	Intact	Ivory	Kitchen	5	Negative	< LOD
28	Door Jamb	Wood	C	Intact	Ivory	Kitchen	5	Negative	< LOD
29	Window Casing	Wood	B	Intact	Ivory	Kitchen	5	Positive	1.6
30	Window Sash	Metal	B	Intact	White	Kitchen	5	Negative	< LOD
31	Cabinet	Wood	D	Intact	Varnish	Kitchen	5	Negative	< LOD
32	Window Infill	Wood	B	Intact	Ivory	Kitchen	5	Negative	< LOD
33	Window Stop	Wood	B	Intact	Ivory	Kitchen	5	Negative	< LOD
34	Window Sill	Wood	B	Intact	Ivory	Kitchen	5	Negative	< LOD
35	Bifold Door	Metal	B	Intact	White	Utility Closet	5	Negative	< LOD
36	Door Stop	Wood	B	Intact	Ivory	Utility Closet	5	Negative	0.6
37	Wall	Gypsum	A	Intact	Ivory	Bathroom	5	Negative	< LOD
38	Wall	Gypsum	B	Intact	Ivory	Bathroom	5	Negative	< LOD
39	Wall	Gypsum	C	Intact	Ivory	Bathroom	5	Negative	< LOD
40	Wall	Gypsum	D	Intact	Ivory	Bathroom	5	Negative	< LOD
41	Ceiling	Gypsum	-	Intact	Ivory	Bathroom	5	Negative	< LOD

LOD = LIMIT OF DETECTION

PIKE COUNTY HOUSING AUTHORITY

PERRY

Reading #	Component	Substrate	Side	Condition	Color	Room	Unit #	Results	PbC
42	Chair Rail	Wood	D	Intact	Ivory	Bathroom	5	Negative	< LOD
43	Door	Wood	A	Intact	Varnish	Bathroom	5	Negative	< LOD
44	Door Stop	Wood	A	Intact	Ivory	Bathroom	5	Negative	< LOD
45	Bifold Door	Metal	D	Intact	White	Living Room	5	Negative	< LOD
46	Door Stop	Wood	D	Intact	White	Living Room	5	Negative	0.6
47	Shelf	Metal	D	Intact	Ivory	Living Room	5	Negative	< LOD
48	Wall	Gypsum	A	Intact	Ivory	Bedroom	5	Negative	< LOD
49	Wall	Gypsum	B	Intact	Ivory	Bedroom	5	Negative	< LOD
50	Wall	Gypsum	C	Intact	Ivory	Bedroom	5	Negative	< LOD
51	Wall	Gypsum	D	Intact	Ivory	Bedroom	5	Negative	< LOD
52	Ceiling	Gypsum	-	Intact	Ivory	Bedroom	5	Negative	< LOD
53	Door	Wood	C	Intact	Ivory	Bedroom	5	Negative	< LOD
54	Door Casing	Wood	C	Intact	Ivory	Bedroom	5	Negative	< LOD
55	Window Casing	Wood	A	Intact	Ivory	Bedroom	5	Positive	1.8
56	Window Sash	Metal	A	Intact	White	Bedroom	5	Negative	< LOD
57	Wall	Gypsum	A	Intact	Ivory	Living Room	6	Negative	< LOD
58	Wall	Gypsum	B	Intact	Ivory	Living Room	6	Negative	< LOD
59	Wall	Gypsum	C	Intact	Ivory	Living Room	6	Negative	< LOD
60	Wall	Gypsum	D	Intact	Ivory	Living Room	6	Negative	< LOD
61	Ceiling	Gypsum	-	Intact	Ivory	Living Room	6	Negative	< LOD
62	Door	Metal	A	Intact	Ivory	Living Room	6	Negative	< LOD
63	Door Casing	Wood	A	Intact	Ivory	Living Room	6	Negative	< LOD
64	Window Casing	Wood	D	Intact	Ivory	Living Room	6	Negative	< LOD
65	Window Sill	Wood	D	Intact	Ivory	Living Room	6	Negative	< LOD
66	Bifold Door	Metal	A	Intact	White	Living Room	6	Negative	< LOD
67	Door Stop	Wood	A	Intact	Ivory	Living Room	6	Negative	0.4
68	Window Infill	Wood	D	Intact	Ivory	Living Room	6	Negative	< LOD
69	Shelf	Metal	B	Intact	Ivory	Living Room	6	Negative	< LOD
70	Window Casing	Wood	D	Intact	Ivory	Living Room	6	Negative	< LOD
71	Wall	Gypsum	A	Intact	Ivory	Utility Closet	6	Negative	< LOD
72	Wall	Gypsum	B	Intact	Ivory	Utility Closet	6	Negative	< LOD
73	Wall	Gypsum	C	Intact	Ivory	Utility Closet	6	Negative	< LOD
74	Wall	Gypsum	D	Intact	Ivory	Utility Closet	6	Negative	< LOD
75	Ceiling	Gypsum	-	Intact	Ivory	Utility Closet	6	Negative	< LOD
76	Bifold Door	Metal	D	Intact	White	Utility Closet	6	Negative	< LOD
77	Door Stop	Wood	D	Intact	Ivory	Utility Closet	6	Positive	1
78	Wall	Gypsum	A	Intact	Ivory	Kitchen	6	Negative	< LOD
79	Wall	Gypsum	B	Intact	Ivory	Kitchen	6	Negative	< LOD
80	Wall	Gypsum	C	Intact	Ivory	Kitchen	6	Negative	< LOD
81	Wall	Gypsum	D	Intact	Ivory	Kitchen	6	Negative	< LOD
82	Ceiling	Gypsum	-	Intact	Ivory	Kitchen	6	Negative	< LOD

LOD = LIMIT OF DETECTION

PIKE COUNTY HOUSING AUTHORITY
PERRY

Reading #	Component	Substrate	Side	Condition	Color	Room	Unit #	Results	PbC
83	Door Casing	Wood	C	Intact	Ivory	Kitchen	6	Negative	< LOD
84	Door	Metal	C	Intact	White	Kitchen	6	Negative	< LOD
85	Door Stop	Wood	C	Intact	Ivory	Kitchen	6	Negative	< LOD
86	Window Casing	Wood	D	Intact	Ivory	Kitchen	6	Negative	< LOD
87	Window Sash	Metal	D	Intact	White	Kitchen	6	Negative	< LOD
88	Cabinet	Wood	B	Intact	Brown	Kitchen	6	Negative	< LOD
89	Window Infill	Wood	A	Intact	Ivory	Kitchen	6	Negative	< LOD
90	Wall	Gypsum	A	Intact	Ivory	Bathroom	6	Negative	< LOD
91	Wall	Gypsum	B	Intact	Ivory	Bathroom	6	Negative	< LOD
92	Wall	Gypsum	C	Intact	Ivory	Bathroom	6	Negative	< LOD
93	Wall	Gypsum	D	Intact	Ivory	Bathroom	6	Negative	< LOD
94	Ceiling	Gypsum	-	Intact	Ivory	Bathroom	6	Negative	< LOD
95	Chair Rail	Wood	B	Intact	Ivory	Bathroom	6	Negative	< LOD
96	Door Casing	Wood	A	Intact	Ivory	Bathroom	6	Positive	1
97	Door	Wood	A	Intact	Brown	Bathroom	6	Negative	< LOD
98	Wall	Gypsum	A	Intact	Ivory	Bedroom	6	Negative	< LOD
99	Wall	Gypsum	B	Intact	Ivory	Bedroom	6	Negative	< LOD
100	Wall	Gypsum	C	Intact	Ivory	Bedroom	6	Negative	< LOD
101	Wall	Gypsum	D	Intact	Ivory	Bedroom	6	Negative	< LOD
102	Ceiling	Gypsum	-	Intact	Ivory	Bedroom	6	Negative	< LOD
103	Door	Wood	C	Intact	Ivory	Bedroom	6	Negative	< LOD
104	Door Casing	Wood	C	Intact	Brown	Bedroom	6	Negative	< LOD
105	Window Casing	Wood	A	Intact	Ivory	Bedroom	6	Negative	< LOD
106	Window Sash	Metal	A	Intact	White	Bedroom	6	Negative	< LOD
107	Door	Metal	A	Intact	White	Exterior	D	Negative	< LOD
108	Door Casing	Metal	A	Intact	White	Exterior	D	Negative	< LOD
109	Window	Metal	A	Intact	White	Exterior	D	Negative	< LOD
110	Window Casing	Metal	A	Intact	White	Exterior	D	Negative	< LOD
111	Soffit	Metal	A	Intact	White	Exterior	D	Negative	< LOD
112	Gutter	Metal	A	Intact	White	Exterior	D	Negative	< LOD
113	Downspout	Metal	A	Intact	White	Exterior	D	Negative	< LOD
114	Facia	Metal	A	Intact	White	Exterior	D	Negative	< LOD
115	Stripping	Concrete	A	Peeling	Yellow	Exterior	D	Negative	< LOD
116	Wall	Gypsum	A	Intact	Ivory	Living Room	1	Negative	< LOD
117	Wall	Gypsum	B	Intact	Ivory	Living Room	1	Negative	< LOD
118	Wall	Gypsum	C	Intact	Ivory	Living Room	1	Negative	< LOD
119	Wall	Gypsum	D	Intact	Ivory	Living Room	1	Negative	< LOD
120	Ceiling	Gypsum	-	Intact	Ivory	Living Room	1	Negative	< LOD
121	Door	Metal	A	Intact	White	Living Room	1	Negative	< LOD
122	Door Casing	Metal	A	Intact	Ivory	Living Room	1	Negative	< LOD
123	Window Sash	Metal	A	Intact	White	Living Room	1	Negative	< LOD

LOD = LIMIT OF DETECTION

PIKE COUNTY HOUSING AUTHORITY

PERRY

Reading #	Component	Substrate	Side	Condition	Color	Room	Unit #	Results	PbC
124	Window Sill	Wood	A	Intact	Ivory	Living Room	1	Negative	< LOD
125	Baseboard	Wood	D	Intact	Ivory	Living Room	1	Negative	< LOD
126	Wall	Wood	D	Intact	Ivory	Living Room	1	Negative	< LOD
127	Bifold Door	Metal	C	Intact	White	Kitchen	1	Negative	< LOD
128	Wall	Gypsum	A	Intact	Ivory	Kitchen	1	Negative	< LOD
129	Wall	Gypsum	B	Intact	Ivory	Kitchen	1	Negative	< LOD
130	Wall	Gypsum	C	Intact	Ivory	Kitchen	1	Negative	< LOD
131	Wall	Gypsum	D	Intact	Ivory	Kitchen	1	Negative	< LOD
132	Ceiling	Gypsum	-	Intact	Ivory	Kitchen	1	Negative	< LOD
133	Window Sash	Metal	A	Intact	White	Kitchen	1	Negative	< LOD
134	Window Casing	Wood	A	Intact	Ivory	Kitchen	1	Negative	< LOD
135	Baseboard	Wood	A	Intact	White	Kitchen	1	Negative	< LOD
136	Cabinet	Wood	D	Intact	Varnish	Kitchen	1	Negative	< LOD
137	Bifold Door	Wood	C	Intact	White	Utility Closet	1	Negative	< LOD
138	Wall	Gypsum	A	Intact	Ivory	Utility Closet	1	Negative	< LOD
139	Wall	Gypsum	B	Intact	Ivory	Utility Closet	1	Negative	< LOD
140	Wall	Gypsum	C	Intact	Ivory	Utility Closet	1	Negative	< LOD
141	Wall	Gypsum	D	Intact	Ivory	Utility Closet	1	Negative	< LOD
142	Ceiling	Gypsum	-	Intact	Ivory	Utility Closet	1	Negative	< LOD
143	Attic Access	Wood	-	Intact	Ivory	Utility Closet	1	Negative	< LOD
144	Baseboard	Wood	A	Intact	Ivory	Utility Closet	1	Negative	< LOD
145	Shelf	Wood	C	Intact	Ivory	Utility Closet	1	Negative	< LOD
146	Wall	Gypsum	A	Intact	Ivory	Bedroom	1	Negative	< LOD
147	Wall	Gypsum	B	Intact	Ivory	Bedroom	1	Negative	< LOD
148	Wall	Gypsum	C	Intact	Ivory	Bedroom	1	Negative	< LOD
149	Wall	Gypsum	D	Intact	Ivory	Bedroom	1	Negative	< LOD
150	Ceiling	Gypsum	-	Intact	Ivory	Bedroom	1	Negative	< LOD
151	Baseboard	Wood	A	Intact	Ivory	Bedroom	1	Negative	< LOD
152	Door	Wood	A	Intact	Varnish	Bedroom	1	Negative	< LOD
153	Door Casing	Wood	A	Intact	Ivory	Bedroom	1	Negative	< LOD
154	Bifold Door	Wood	D	Intact	White	Bedroom	1	Negative	< LOD
155	Shelf	Wood	D	Intact	Ivory	Bedroom	1	Negative	< LOD
156	Window Casing	Wood	B	Intact	Ivory	Bedroom	1	Negative	< LOD
157	Sash	Metal	B	Intact	White	Bedroom	1	Negative	< LOD
158	Wall	Gypsum	A	Intact	Ivory	Bedroom	1	Negative	< LOD
159	Wall	Gypsum	B	Intact	Ivory	Bathroom	1	Negative	< LOD
160	Wall	Gypsum	C	Intact	Ivory	Bathroom	1	Negative	< LOD
161	Wall	Gypsum	D	Intact	Ivory	Bathroom	1	Negative	< LOD
162	Ceiling	Gypsum	-	Intact	Ivory	Bathroom	1	Negative	< LOD
163	Baseboard	Wood	A	Intact	Ivory	Bathroom	1	Negative	< LOD
164	Chair Rail	Wood	D	Intact	Ivory	Bathroom	1	Negative	< LOD

LOD = LIMIT OF DETECTION

PIKE COUNTY HOUSING AUTHORITY

PERRY

Reading #	Component	Substrate	Side	Condition	Color	Room	Unit #	Results	PbC
165	Door	Wood	B	Intact	Brown	Bathroom	1	Negative	< LOD
166	Door Casing	Wood	B	Intact	Ivory	Bathroom	1	Negative	< LOD
167	Wall	Gypsum	A	Intact	Ivory	Living Room	2	Negative	< LOD
168	Wall	Gypsum	B	Intact	Ivory	Living Room	2	Negative	< LOD
169	Wall	Gypsum	C	Intact	Ivory	Living Room	2	Negative	< LOD
170	Wall	Gypsum	D	Intact	Ivory	Living Room	2	Negative	< LOD
171	Ceiling	Gypsum	-	Intact	Ivory	Living Room	2	Negative	< LOD
172	Door	Metal	A	Intact	Ivory	Living Room	2	Negative	< LOD
173	Door Casing	Wood	A	Intact	Ivory	Living Room	2	Negative	< LOD
174	Window Casing	Wood	A	Intact	Ivory	Living Room	2	Negative	< LOD
175	Sash	Metal	A	Intact	White	Living Room	2	Negative	< LOD
176	Bifold Door	Wood	C	Intact	White	Living Room	2	Negative	< LOD
177	Wall	Wood	B	Intact	Ivory	Living Room	2	Negative	< LOD
178	Wall	Gypsum	A	Intact	Ivory	Kitchen	2	Negative	< LOD
179	Wall	Gypsum	B	Intact	Ivory	Kitchen	2	Negative	< LOD
180	Wall	Gypsum	C	Intact	Ivory	Kitchen	2	Negative	< LOD
181	Wall	Gypsum	D	Intact	Ivory	Kitchen	2	Negative	< LOD
182	Ceiling	Gypsum	-	Intact	Ivory	Kitchen	2	Negative	< LOD
183	Window Sash	Metal	A	Intact	White	Kitchen	2	Negative	< LOD
184	Window Casing	Wood	A	Intact	Ivory	Kitchen	2	Negative	< LOD
185	Cabinet	Wood	B	Intact	Varnish	Kitchen	2	Negative	< LOD
186	Bifold Door	Metal	C	Intact	White	Kitchen	2	Negative	< LOD
187	Door Stop	Wood	C	Intact	Ivory	Utility Closet	2	Positive	1.4
188	Wall	Gypsum	A	Intact	Ivory	Utility Closet	2	Negative	< LOD
189	Wall	Gypsum	B	Intact	Ivory	Utility Closet	2	Negative	< LOD
190	Wall	Gypsum	C	Intact	Ivory	Utility Closet	2	Negative	< LOD
191	Wall	Gypsum	D	Intact	Ivory	Utility Closet	2	Negative	< LOD
192	Ceiling	Gypsum	-	Intact	Ivory	Utility Closet	2	Negative	< LOD
193	Attic Access	Wood	-	Intact	Ivory	Utility Closet	2	Negative	< LOD
194	Pipe Hanger	Metal	-	Intact	Ivory	Utility Closet	2	Negative	< LOD
195	Shelf	Metal	C	Intact	Ivory	Utility Closet	2	Negative	< LOD
196	Wall	Gypsum	A	Intact	Ivory	Bedroom	2	Negative	< LOD
197	Wall	Gypsum	B	Intact	Ivory	Bedroom	2	Negative	< LOD
198	Wall	Gypsum	C	Intact	Ivory	Bedroom	2	Negative	< LOD
199	Ceiling	Gypsum	D	Intact	Ivory	Bedroom	2	Negative	< LOD
200	Ceiling	Gypsum	-	Intact	Ivory	Bedroom	2	Negative	< LOD
201	Door	Wood	A	Intact	Varnish	Bedroom	2	Negative	< LOD
202	Casing	Wood	A	Intact	Ivory	Bedroom	2	Negative	< LOD
203	Window Casing	Wood	D	Intact	Ivory	Bedroom	2	Negative	< LOD
204	Window Sash	Metal	D	Intact	White	Bedroom	2	Negative	< LOD
205	Bifold Door	Metal	B	Intact	White	Bedroom	2	Negative	< LOD

LOD = LIMIT OF DETECTION

PIKE COUNTY HOUSING AUTHORITY

PERRY

Reading #	Component	Substrate	Side	Condition	Color	Room	Unit #	Results	PbC
206	Shelf	Metal	B	Intact	Ivory	Bedroom	2	Negative	< LOD
207	Wall	Gypsum	A	Intact	Ivory	Bathroom	2	Negative	< LOD
208	Wall	Gypsum	B	Intact	Ivory	Bathroom	2	Negative	< LOD
209	Wall	Gypsum	C	Intact	Ivory	Bathroom	2	Negative	< LOD
210	Wall	Gypsum	D	Intact	Ivory	Bathroom	2	Negative	< LOD
211	Ceiling	Gypsum	-	Intact	Ivory	Bathroom	2	Negative	< LOD
212	Chair Rail	Wood	A	Intact	Ivory	Bathroom	2	Negative	< LOD
213	Door Casing	Wood	D	Intact	Ivory	Bathroom	2	Negative	< LOD
214	Door	Wood	D	Intact	Varnish	Bathroom	2	Negative	< LOD
215	Door	Metal	A	Intact	White	Exterior	C	Negative	< LOD
216	Door Casing	Metal	A	Intact	White	Exterior	C	Negative	< LOD
217	Window Sash	Metal	A	Intact	White	Exterior	C	Negative	< LOD
218	Window Casing	Metal	A	Intact	White	Exterior	C	Negative	< LOD
219	Post	Metal	A	Intact	Black	Exterior	C	Negative	< LOD
220	Wall	Concrete	A	Intact	White	Exterior	C	Negative	< LOD
221	Clothes Line	Metal	A	Intact	White	Exterior	C	Negative	< LOD
222	Trash Basket	Metal	A	Intact	White	Exterior	C	Negative	< LOD
223	Downspout	Metal	A	Intact	White	Exterior	C	Negative	< LOD
224	Gutter	Metal	A	Intact	White	Exterior	C	Negative	< LOD
225	Facia	Metal	A	Intact	White	Exterior	C	Negative	< LOD
226	Soffit	Metal	A	Intact	White	Exterior	C	Positive	1
227	Stripping	Concrete	A	Peeling	Yellow	Exterior	C	Negative	< LOD
228	Calibrate								1
229	Calibrate								1
230	Calibrate								0.9
231	Calibrate								5.89
232	Calibrate								1
233	Calibrate								0.9
234	Calibrate								0.9
235	Wall	Gypsum	A	Intact	Ivory	Living Room	3	Negative	< LOD
236	Wall	Gypsum	B	Intact	Ivory	Living Room	3	Negative	< LOD
237	Wall	Gypsum	C	Intact	Ivory	Living Room	3	Negative	< LOD
238	Wall	Gypsum	D	Intact	Ivory	Living Room	3	Negative	< LOD
239	Ceiling	Gypsum	-	Intact	Ivory	Living Room	3	Negative	< LOD
240	Door	Metal	A	Intact	White	Living Room	3	Negative	< LOD
241	Door Casing	Metal	A	Intact	Ivory	Living Room	3	Negative	< LOD
242	Window Casing	Wood	A	Intact	Ivory	Living Room	3	Negative	0.6
243	Sash	Metal	A	Intact	White	Living Room	3	Negative	< LOD
244	Bifold Door	Metal	C	Intact	White	Living Room	3	Negative	< LOD
245	Wall	Wood	B	Intact	Ivory	Living Room	3	Negative	< LOD
246	Wall	Gypsum	A	Intact	Ivory	Kitchen	3	Negative	< LOD

LOD = LIMIT OF DETECTION

PIKE COUNTY HOUSING AUTHORITY

PERRY

Reading #	Component	Substrate	Side	Condition	Color	Room	Unit #	Results	PbC
247	Wall	Gypsum	B	Intact	Ivory	Kitchen	3	Negative	< LOD
248	Wall	Gypsum	C	Intact	Ivory	Kitchen	3	Negative	< LOD
249	Wall	Gypsum	D	Intact	Ivory	Kitchen	3	Negative	< LOD
250	Ceiling	Gypsum	-	Intact	Ivory	Kitchen	3	Negative	< LOD
251	Window Sash	Metal	A	Intact	White	Kitchen	3	Negative	< LOD
252	Window Casing	Wood	A	Intact	Ivory	Kitchen	3	Negative	< LOD
253	Bifold Door	Metal	C	Intact	White	Kitchen	3	Negative	< LOD
254	Door Stop	Wood	C	Intact	Ivory	Kitchen	3	Negative	0.5
255	Cabinet	Wood	B	Intact	Varnish	Kitchen	3	Negative	< LOD
256	Wall	Gypsum	A	Intact	Ivory	Utility Closet	3	Negative	< LOD
257	Wall	Gypsum	B	Intact	Ivory	Utility Closet	3	Negative	< LOD
258	Wall	Gypsum	C	Intact	Ivory	Utility Closet	3	Negative	< LOD
259	Wall	Gypsum	D	Intact	Ivory	Utility Closet	3	Negative	< LOD
260	Ceiling	Gypsum	-	Intact	Ivory	Utility Closet	3	Negative	< LOD
261	Shelf	Metal	B	Intact	Ivory	Utility Closet	3	Negative	< LOD
262	Wall	Gypsum	A	Intact	Ivory	Bedroom	3	Negative	< LOD
263	Wall	Gypsum	B	Intact	Ivory	Bedroom	3	Negative	< LOD
264	Wall	Gypsum	C	Intact	Ivory	Bedroom	3	Negative	< LOD
265	Wall	Gypsum	D	Intact	Ivory	Bedroom	3	Negative	< LOD
266	Ceiling	Gypsum	-	Intact	Ivory	Bedroom	3	Negative	< LOD
267	Window Sash	Metal	D	Intact	White	Bedroom	3	Negative	< LOD
268	Window Sill	Wood	D	Intact	Ivory	Bedroom	3	Negative	< LOD
269	Bifold Door	Metal	A	Intact	White	Bedroom	3	Negative	< LOD
270	Door Stop	Wood	A	Intact	Ivory	Bedroom	3	Positive	1
271	Door	Wood	A	Intact	Varnish	Bedroom	3	Negative	< LOD
272	Door Jamb	Wood	A	Intact	Ivory	Bedroom	3	Negative	< LOD
273	Shelf	Metal	A	Intact	Ivory	Bedroom	3	Negative	< LOD
274	Wall	Gypsum	A	Intact	Ivory	Bathroom	3	Negative	< LOD
275	Wall	Gypsum	B	Intact	Ivory	Bathroom	3	Negative	< LOD
276	Wall	Gypsum	C	Intact	Ivory	Bathroom	3	Negative	< LOD
277	Wall	Gypsum	D	Intact	Ivory	Bathroom	3	Negative	< LOD
278	Ceiling	Gypsum	-	Intact	Ivory	Bathroom	3	Negative	< LOD
279	Chair Rail	Wood	D	Intact	Ivory	Living Room	3	Negative	< LOD
280	Door	Wood	D	Intact	Varnish	Living Room	3	Negative	< LOD
281	Door Casing	Wood	D	Intact	Ivory	Living Room	3	Negative	< LOD
282	Wall	Gypsum	A	Intact	Ivory	Living Room	8	Negative	< LOD
283	Wall	Gypsum	B	Intact	Ivory	Living Room	8	Negative	< LOD
284	Wall	Gypsum	C	Intact	Ivory	Living Room	8	Negative	< LOD
285	Wall	Gypsum	D	Intact	Ivory	Living Room	8	Negative	< LOD
286	Ceiling	Gypsum	-	Intact	Ivory	Living Room	8	Negative	< LOD
287	Door	Metal	A	Intact	White	Living Room	8	Negative	< LOD

LOD = LIMIT OF DETECTION

PIKE COUNTY HOUSING AUTHORITY
PERRY

Reading #	Component	Substrate	Side	Condition	Color	Room	Unit #	Results	PbC
288	Door Casing	Wood	A	Intact	Ivory	Living Room	8	Negative	< LOD
289	Window Casing	Wood	D	Intact	Ivory	Living Room	8	Negative	< LOD
290	Window Sash	Metal	D	Intact	White	Living Room	8	Negative	< LOD
291	Bifold Door	Metal	B	Intact	White	Living Room	8	Negative	< LOD
292	Door Stop	Wood	B	Intact	Ivory	Living Room	8	Negative	0.5
293	Shelf	Metal	B	Intact	Ivory	Living Room	8	Negative	< LOD
294	Shelf Support	Wood	B	Intact	Ivory	Living Room	8	Negative	< LOD
295	Wall	Wood	C	Intact	Ivory	Living Room	8	Negative	< LOD
296	Wall	Gypsum	A	Intact	Ivory	Kitchen	8	Negative	< LOD
297	Wall	Gypsum	B	Intact	Ivory	Kitchen	8	Negative	< LOD
298	Wall	Gypsum	C	Intact	Ivory	Kitchen	8	Negative	< LOD
299	Wall	Gypsum	D	Intact	Ivory	Kitchen	8	Negative	< LOD
300	Ceiling	Gypsum	-	Intact	Ivory	Kitchen	8	Negative	< LOD
301	Door	Metal	C	Intact	White	Kitchen	8	Negative	< LOD
302	Door Casing	Wood	C	Intact	Ivory	Kitchen	8	Negative	< LOD
303	Cabinet	Wood	B	Intact	Varnish	Kitchen	8	Negative	< LOD
304	Baseboard	Wood	A	Intact	Ivory	Kitchen	8	Negative	< LOD
305	Window Sash	Metal	D	Intact	White	Kitchen	8	Negative	< LOD
306	Window Casing	Wood	D	Intact	Ivory	Kitchen	8	Negative	< LOD
307	Window Infill	Wood	D	Intact	Ivory	Kitchen	8	Negative	< LOD
308	Window Infill	Wood	D	Intact	Ivory	Living Room	8	Negative	< LOD
309	Wall	Gypsum	A	Intact	Ivory	Bedroom # 1	8	Negative	< LOD
310	Wall	Gypsum	B	Intact	Ivory	Bedroom # 1	8	Negative	< LOD
311	Wall	Gypsum	C	Intact	Ivory	Bedroom # 1	8	Negative	< LOD
312	Wall	Gypsum	D	Intact	Ivory	Bedroom # 1	8	Negative	< LOD
313	Ceiling	Gypsum	-	Intact	Ivory	Bedroom # 1	8	Negative	< LOD
314	Door	Wood	C	Intact	Ivory	Bedroom # 1	8	Negative	< LOD
315	Door Casing	Wood	C	Intact	Ivory	Bedroom # 1	8	Negative	< LOD
316	Window Casing	Wood	A	Intact	Ivory	Bedroom # 1	8	Negative	< LOD
317	Window Sash	Metal	A	Intact	White	Bedroom # 1	8	Negative	< LOD
318	Bifold Door	Metal	D	Intact	White	Bedroom # 1	8	Negative	< LOD
319	Shelf	Metal	D	Intact	Ivory	Bedroom # 1	8	Negative	< LOD
320	Shelf Support	Metal	D	Intact	Ivory	Bedroom # 1	8	Negative	< LOD
321	Wall	Gypsum	A	Intact	Ivory	Utility Closet	8	Negative	< LOD
322	Wall	Gypsum	B	Intact	Ivory	Utility Closet	8	Negative	< LOD
323	Wall	Gypsum	C	Intact	Ivory	Utility Closet	8	Negative	< LOD
324	Wall	Gypsum	D	Intact	Ivory	Utility Closet	8	Negative	< LOD
325	Ceiling	Gypsum	-	Intact	Ivory	Utility Closet	8	Negative	< LOD
326	Attic Access	Wood	-	Intact	Ivory	Utility Closet	8	Negative	< LOD
327	Door Jamb	Wood	D	Intact	Ivory	Utility Closet	8	Negative	< LOD
328	Door	Wood	D	Intact	Ivory	Utility Closet	8	Negative	< LOD

LOD = LIMIT OF DETECTION

PIKE COUNTY HOUSING AUTHORITY

PERRY

Reading #	Component	Substrate	Side	Condition	Color	Room	Unit #	Results	PbC
329	Shelf	Metal	A	Intact	Ivory	Utility Closet	8	Negative	< LOD
330	Wall	Gypsum	A	Intact	Ivory	Bedroom # 2	8	Negative	< LOD
331	Wall	Gypsum	B	Intact	Ivory	Bedroom # 2	8	Negative	< LOD
332	Wall	Gypsum	C	Intact	Ivory	Bedroom # 2	8	Negative	< LOD
333	Wall	Gypsum	D	Intact	Ivory	Bedroom # 2	8	Negative	< LOD
334	Ceiling	Gypsum	-	Intact	Ivory	Bedroom # 2	8	Negative	< LOD
335	Window Casing	Wood	C	Intact	Ivory	Bedroom # 2	8	Negative	< LOD
336	Window Sash	Metal	C	Intact	White	Bedroom # 2	8	Negative	< LOD
337	Door	Wood	D	Intact	Ivory	Bedroom # 2	8	Negative	< LOD
338	Door Casing	Wood	D	Intact	Ivory	Bedroom # 2	8	Negative	< LOD
339	Bifold Door	Metal	A	Intact	White	Bedroom # 2	8	Negative	< LOD
340	Door Stop	Wood	A	Intact	Ivory	Bedroom # 2	8	Negative	0.6
341	Shelf	Metal	A	Intact	Ivory	Bedroom # 2	8	Negative	< LOD
342	Wall	Gypsum	A	Intact	Ivory	Bathroom	8	Negative	< LOD
343	Wall	Gypsum	B	Intact	Ivory	Bathroom	8	Negative	< LOD
344	Wall	Gypsum	C	Intact	Ivory	Bathroom	8	Negative	< LOD
345	Wall	Gypsum	D	Intact	Ivory	Bathroom	8	Negative	< LOD
346	Ceiling	Gypsum	-	Intact	White	Bathroom	8	Negative	< LOD
347	Chair Rail	Wood	C	Intact	Ivory	Bathroom	8	Negative	< LOD
348	Door	Wood	A	Intact	Varnish	Bathroom	8	Negative	< LOD
349	Door Casing	Wood	A	Intact	Ivory	Bathroom	8	Negative	< LOD
350	Wall	Gypsum	A	Intact	Ivory	Living Room	9	Negative	< LOD
351	Wall	Gypsum	B	Intact	Ivory	Living Room	9	Negative	< LOD
352	Wall	Gypsum	C	Intact	Ivory	Living Room	9	Negative	< LOD
353	Wall	Gypsum	D	Intact	Ivory	Living Room	9	Negative	< LOD
354	Ceiling	Gypsum	-	Intact	Ivory	Living Room	9	Negative	< LOD
355	Door	Metal	A	Intact	Ivory	Living Room	9	Negative	< LOD
356	Door Casing	Metal	A	Intact	Ivory	Living Room	9	Negative	< LOD
357	Window Casing	Wood	B	Intact	Ivory	Living Room	9	Negative	< LOD
358	Window Sash	Metal	B	Intact	White	Living Room	9	Negative	< LOD
359	Window Infill	Wood	B	Intact	Ivory	Living Room	9	Negative	< LOD
360	Wall	Wood	C	Intact	Ivory	Living Room	9	Negative	< LOD
361	Wall	Gypsum	A	Intact	Ivory	Kitchen	9	Negative	< LOD
362	Wall	Gypsum	B	Intact	Ivory	Kitchen	9	Negative	< LOD
363	Wall	Gypsum	C	Intact	Ivory	Kitchen	9	Negative	< LOD
364	Wall	Gypsum	D	Intact	Ivory	Kitchen	9	Negative	< LOD
365	Ceiling	Gypsum	-	Intact	Ivory	Kitchen	9	Negative	< LOD
366	Door	Metal	C	Intact	Ivory	Kitchen	9	Negative	< LOD
367	Door Casing	Wood	C	Intact	Ivory	Kitchen	9	Negative	< LOD
368	Window Casing	Wood	B	Intact	Ivory	Kitchen	9	Negative	< LOD
369	Sash	Metal	B	Intact	White	Kitchen	9	Negative	< LOD

LOD = LIMIT OF DETECTION

PIKE COUNTY HOUSING AUTHORITY
PERRY

Reading #	Component	Substrate	Side	Condition	Color	Room	Unit #	Results	PbC
370	Window Infill	Wood	B	Intact	Ivory	Kitchen	9	Negative	< LOD
371	Cabinet	Wood	D	Intact	Varnish	Kitchen	9	Negative	< LOD
372	Wall	Gypsum	A	Intact	Ivory	Utility Closet	9	Negative	< LOD
373	Wall	Gypsum	B	Intact	Ivory	Utility Closet	9	Negative	< LOD
374	Wall	Gypsum	C	Intact	Ivory	Utility Closet	9	Negative	< LOD
375	Wall	Gypsum	D	Intact	Ivory	Utility Closet	9	Negative	< LOD
376	Ceiling	Gypsum	-	Intact	Ivory	Utility Closet	9	Negative	< LOD
377	Door	Wood	A	Intact	Varnish	Utility Closet	9	Negative	< LOD
378	Door Casing	Wood	A	Intact	Ivory	Utility Closet	9	Negative	< LOD
379	Shelf	Metal	C	Intact	Ivory	Utility Closet	9	Negative	< LOD
380	Wall	Gypsum	A	Intact	Ivory	Bathroom	9	Negative	< LOD
381	Wall	Gypsum	B	Intact	Ivory	Bathroom	9	Negative	< LOD
382	Wall	Gypsum	C	Intact	Ivory	Bathroom	9	Negative	< LOD
383	Wall	Gypsum	D	Intact	Ivory	Bathroom	9	Negative	< LOD
384	Ceiling	Gypsum	-	Intact	Ivory	Bathroom	9	Negative	< LOD
385	Chair Rail	Wood	D	Intact	Ivory	Bathroom	9	Negative	< LOD
386	Door	Wood	A	Intact	Varnish	Bathroom	9	Negative	< LOD
387	Door Stop	Wood	A	Intact	Ivory	Bathroom	9	Negative	< LOD
388	Wall	Gypsum	A	Intact	Ivory	Bedroom # 1	9	Negative	< LOD
389	Wall	Gypsum	B	Intact	Ivory	Bedroom # 1	9	Negative	< LOD
390	Wall	Gypsum	C	Intact	Ivory	Bedroom # 1	9	Negative	< LOD
391	Wall	Gypsum	D	Intact	Ivory	Bedroom # 1	9	Negative	< LOD
392	Ceiling	Gypsum	-	Intact	Ivory	Bedroom # 1	9	Negative	< LOD
393	Window Sash	Metal	C	Intact	White	Bedroom # 1	9	Negative	< LOD
394	Window Casing	Wood	C	Intact	Ivory	Bedroom # 1	9	Negative	< LOD
395	Door Casing	Wood	B	Intact	Ivory	Bedroom # 1	9	Negative	< LOD
396	Door	Wood	B	Intact	Varnish	Bedroom # 1	9	Negative	< LOD
397	Bifold Door	Metal	A	Intact	Ivory	Bedroom # 1	9	Negative	< LOD
398	Door Stop	Wood	A	Intact	Ivory	Bedroom # 1	9	Positive	1.4
399	Shelf	Metal	A	Intact	Ivory	Bedroom # 1	9	Negative	< LOD
400	Wall	Gypsum	A	Intact	Ivory	Bedroom # 2	9	Negative	< LOD
401	Wall	Gypsum	B	Intact	Ivory	Bedroom # 2	9	Negative	< LOD
402	Wall	Gypsum	C	Intact	Ivory	Bedroom # 2	9	Negative	< LOD
403	Wall	Gypsum	D	Intact	Ivory	Bedroom # 2	9	Negative	< LOD
404	Ceiling	Gypsum	-	Intact	Ivory	Bedroom # 2	9	Negative	< LOD
405	Window Casing	Wood	A	Intact	Ivory	Bedroom # 2	9	Negative	< LOD
406	Sash	Metal	A	Intact	White	Bedroom # 2	9	Negative	< LOD
407	Door Casing	Wood	C	Intact	Ivory	Bedroom # 2	9	Negative	< LOD
408	Door	Wood	C	Intact	Varnish	Bedroom # 2	9	Negative	< LOD
409	Door	Metal	C	Intact	Ivory	Bedroom # 2	9	Negative	< LOD
410	Door Stop	Wood	C	Intact	Ivory	Bedroom # 2	9	Negative	< LOD

LOD = LIMIT OF DETECTION

PIKE COUNTY HOUSING AUTHORITY
PERRY

Reading #	Component	Substrate	Side	Condition	Color	Room	Unit #	Results	PbC
411	Wall	Gypsum	A	Intact	Ivory	Bedroom # 2	9	Negative	< LOD
412	Wall	Gypsum	B	Intact	Ivory	Bedroom # 3	9	Negative	< LOD
413	Wall	Gypsum	C	Intact	Ivory	Bedroom # 3	9	Negative	< LOD
414	Wall	Gypsum	D	Intact	Ivory	Bedroom # 3	9	Negative	< LOD
415	Ceiling	Gypsum	-	Intact	Ivory	Bedroom # 3	9	Negative	< LOD
416	Window Casing	Wood	A	Intact	Ivory	Bedroom # 3	9	Negative	< LOD
417	Window Sash	Metal	A	Intact	White	Bedroom # 3	9	Negative	< LOD
418	Door	Wood	C	Intact	Varnish	Bedroom # 3	9	Negative	< LOD
419	Door Casing	Wood	C	Intact	Ivory	Bedroom # 3	9	Negative	< LOD
420	Bifold Door	Metal	C	Intact	Ivory	Bedroom # 3	9	Negative	< LOD
421	Door Stop	Wood	C	Intact	Ivory	Bedroom # 3	9	Negative	< LOD
422	Shelf	Metal	C	Intact	Ivory	Bedroom # 3	9	Negative	< LOD
423	Door	Metal	C	Intact	White	Exterior	F	Negative	< LOD
424	Door Casing	Metal	C	Intact	White	Exterior	F	Negative	< LOD
425	Window Sash	Metal	C	Intact	White	Exterior	F	Negative	< LOD
426	Window Casing	Metal	C	Intact	White	Exterior	F	Negative	< LOD
427	Soffit	Metal	C	Intact	White	Exterior	F	Negative	< LOD
428	Facia	Metal	C	Intact	White	Exterior	F	Negative	< LOD
429	Gutter	Metal	C	Intact	White	Exterior	F	Negative	< LOD
430	Downspout	Metal	C	Intact	White	Exterior	F	Negative	< LOD
431	Wall	Block	C	Intact	White	Exterior	F	Negative	< LOD
432	Clothes Line	Metal	C	Intact	Gray	Exterior	F	Negative	< LOD
433	Stripping	Concrete	C	Peeling	Yellow	Exterior	F	Negative	< LOD
434	Trash Basket	Metal	C	Peeling	Gray	Exterior	F	Negative	< LOD
435	Door	Metal	C	Intact	White	Exterior	F	Negative	< LOD
436	Casing	Metal	C	Intact	White	Exterior	F	Negative	< LOD
437	Window	Metal	C	Intact	White	Exterior	F	Negative	< LOD
438	Casing	Metal	C	Intact	White	Exterior	F	Negative	< LOD
439	Soffit	Metal	C	Intact	White	Exterior	F	Negative	< LOD
440	Facia	Metal	C	Intact	White	Exterior	F	Negative	< LOD
441	Gutter	Metal	C	Intact	White	Exterior	F	Negative	< LOD
442	Downspout	Metal	C	Intact	White	Exterior	F	Negative	< LOD
443	Clothes Line	Metal	C	Intact	Gray	Exterior	F	Negative	< LOD
444	Stripping	Concrete	C	Peeling	Yellow	Exterior	F	Negative	< LOD
445	Calibrate								1
446	Calibrate								0.9
447	Calibrate								1.1

LOD = LIMIT OF DETECTION

PIKE COUNTY HOUSING AUTHORITY
PERRY

Reading #	Component	Substrate	Side	Condition	Color	Room	Unit #	Results	PbC
2	Calibrate								1
3	Calibrate								1
4	Calibrate								1
5	Wall	Gypsum	A	Intact	Ivory	Living Room	10	Negative	< LOD
6	Wall	Gypsum	D	Intact	Ivory	Living Room	10	Negative	< LOD
7	Wall	Gypsum	B	Intact	Ivory	Living Room	10	Negative	< LOD
8	Wall	Gypsum	C	Intact	Ivory	Living Room	10	Negative	< LOD
9	Ceiling	Gypsum		Intact	Ivory	Living Room	10	Negative	< LOD
10	Door Casing	Wood	A	Intact	Ivory	Living Room	10	Negative	< LOD
11	Door	Metal	A	Intact	Ivory	Living Room	10	Negative	< LOD
12	Door Casing	Wood	A	Intact	Ivory	Living Room	10	Negative	< LOD
13	Door Stop	Wood	B	Intact	Ivory	Living Room	10	Negative	< LOD
14	Door	Metal	B	Intact	Ivory	Living Room	10	Negative	< LOD
15	Window Casing	Wood	D	Intact	Ivory	Living Room	10	Negative	< LOD
16	Window Casing	Wood	D	Intact	Ivory	Living Room	10	Negative	< LOD
17	Window Sash	Metal	D	Intact	White	Living Room	10	Negative	< LOD
18	Wall	Wood	A	Intact	Ivory	Kitchen	10	Negative	< LOD
19	Wall	Gypsum	A	Intact	Ivory	Kitchen	10	Negative	< LOD
20	Wall	Gypsum	B	Intact	Ivory	Kitchen	10	Negative	< LOD
21	Wall	Gypsum	C	Intact	Ivory	Kitchen	10	Negative	< LOD
22	Wall	Gypsum	D	Intact	Ivory	Kitchen	10	Negative	< LOD
23	Ceiling	Gypsum		Intact	Ivory	Kitchen	10	Negative	< LOD
24	Door Casing	Wood	C	Intact	Ivory	Kitchen	10	Negative	< LOD
25	Door	Metal	C	Intact	White	Kitchen	10	Negative	< LOD
26	Window Sill	Wood	D	Intact	Ivory	Kitchen	10	Negative	< LOD
27	Jamb	Metal	D	Intact	White	Kitchen	10	Negative	< LOD
28	Window Sash	Metal	D	Intact	White	Kitchen	10	Negative	< LOD
29	Cabinet	Wood	B	Intact	Varnish	Kitchen	10	Negative	< LOD
30	Base	Wood	A	Intact	Ivory	Kitchen	10	Negative	< LOD
31	Door Stop	Wood	D	Intact	Ivory	Living Room	10	Positive	1.1
32	Door	Metal	D	Intact	Ivory	Living Room	10	Negative	< LOD
33	Shelf	Metal	D	Intact	Ivory	Living Room	10	Negative	< LOD
34	Jamb	Wood	A	Intact	Ivory	Bathroom	10	Negative	< LOD
35	Door	Wood	A	Intact	Ivory	Bathroom	10	Negative	< LOD
36	Wall	Gypsum	A	Intact	Ivory	Bathroom	10	Negative	< LOD
37	Wall	Gypsum	B	Intact	Ivory	Bathroom	10	Negative	< LOD
38	Wall	Gypsum	C	Intact	Ivory	Bathroom	10	Negative	< LOD
39	Wall	Gypsum	D	Intact	Ivory	Bathroom	10	Negative	< LOD
40	Ceiling	Gypsum		Intact	Ivory	Bathroom	10	Negative	< LOD
41	Door Casing	Wood	D	Intact	Ivory	Bedroom	10	Negative	< LOD
42	Door	Wood	D	Intact	Ivory	Bedroom	10	Negative	< LOD

LOD = LIMIT OF DETECTION

PIKE COUNTY HOUSING AUTHORITY
PERRY

Reading #	Component	Substrate	Side	Condition	Color	Room	Unit #	Results	PbC
43	Wall	Gypsum	A	Intact	Ivory	Bedroom	10	Negative	< LOD
44	Wall	Gypsum	B	Intact	Ivory	Bedroom	10	Negative	< LOD
45	Wall	Gypsum	C	Intact	Ivory	Bedroom	10	Negative	< LOD
46	Wall	Gypsum	D	Intact	Ivory	Bedroom	10	Negative	< LOD
47	Ceiling	Gypsum		Intact	Ivory	Bedroom	10	Negative	< LOD
48	Window Casing	Wood	C	Intact	Ivory	Bedroom	10	Negative	< LOD
49	Window Sash	Metal	C	Intact	White	Bedroom	10	Negative	< LOD
50	Door Stop	Wood	A	Intact	Ivory	Bedroom	10	Negative	< LOD
51	Door	Metal	A	Intact	White	Bedroom	10	Negative	0.7
52	Shelf	Metal	A	Intact	Ivory	Bedroom	10	Negative	< LOD
53	Support	Wood	A	Intact	Ivory	Bedroom	10	Negative	< LOD
54	Void			Intact	Ivory	Bedroom	10	Negative	< LOD
55	Door	Wood	D	Intact	Ivory	Mechanical	10	Negative	< LOD
56	Jamb	Wood	D	Intact	Ivory	Mechanical	10	Negative	< LOD
57	Wall	Gypsum	A	Intact	Ivory	Mechanical	10	Negative	< LOD
58	Wall	Gypsum	B	Intact	Ivory	Mechanical	10	Negative	< LOD
59	Wall	Gypsum	C	Intact	Ivory	Mechanical	10	Negative	< LOD
60	Wall	Gypsum	D	Intact	Ivory	Mechanical	10	Negative	< LOD
61	Ceiling	Gypsum		Intact	Ivory	Mechanical	10	Negative	< LOD
62	Shelf	Metal	A	Intact	Ivory	Mechanical	10	Negative	< LOD
63	Trim	Wood		Intact	Ivory	Mechanical	10	Negative	< LOD
64	Jamb	Wood	C	Intact	Ivory	Bedroom	10	Negative	0.13
65	Door	Wood	C	Intact	Ivory	Bedroom	10	Negative	< LOD
66	Wall	Gypsum	A	Intact	Ivory	Bedroom	10	Negative	< LOD
67	Wall	Gypsum	B	Intact	Ivory	Bedroom	10	Negative	< LOD
68	Wall	Gypsum	C	Intact	Ivory	Bedroom	10	Negative	< LOD
69	Wall	Gypsum	D	Intact	Ivory	Bedroom	10	Negative	< LOD
70	Ceiling	Gypsum		Intact	Ivory	Bedroom	10	Negative	< LOD
71	Window Casing	Wood	A	Intact	Ivory	Bedroom	10	Negative	< LOD
72	Window Sash	Metal	A	Intact	White	Bedroom	10	Negative	< LOD
73	Shelf	Metal	D	Intact	Ivory	Bedroom	10	Negative	< LOD
74	Door	Metal	D	Intact	Ivory	Bedroom	10	Negative	< LOD
75	Track	Metal	D	Intact	Ivory	Bedroom	10	Negative	< LOD
76	Wall	Gypsum	A	Intact	Ivory	Living Room	11	Negative	< LOD
77	Wall	Gypsum	B	Intact	Ivory	Living Room	11	Negative	< LOD
78	Wall	Gypsum	C	Intact	Ivory	Living Room	11	Negative	< LOD
79	Wall	Gypsum	D	Intact	Ivory	Living Room	11	Negative	< LOD
80	Ceiling	Gypsum		Intact	Ivory	Living Room	11	Negative	< LOD
81	Door Casing	Wood	A	Intact	Ivory	Living Room	11	Negative	< LOD
82	Door	Metal	A	Intact	Ivory	Living Room	11	Negative	< LOD
83	Window Casing	Wood	B	Intact	Ivory	Living Room	11	Negative	< LOD

LOD = LIMIT OF DETECTION

PIKE COUNTY HOUSING AUTHORITY
PERRY

Reading #	Component	Substrate	Side	Condition	Color	Room	Unit #	Results	PbC
84	Window Sash	Metal	B	Intact	White	Living Room	11	Negative	< LOD
85	Wall	Wood	C	Intact	Ivory	Living Room	11	Negative	< LOD
86	Wall	Gypsum	A	Intact	Ivory	Kitchen	11	Negative	< LOD
87	Wall	Gypsum	B	Intact	Ivory	Kitchen	11	Negative	< LOD
88	Wall	Gypsum	C	Intact	Ivory	Kitchen	11	Negative	< LOD
89	Wall	Gypsum	D	Intact	Ivory	Kitchen	11	Negative	< LOD
90	Ceiling	Gypsum		Intact	Ivory	Kitchen	11	Negative	< LOD
91	Door Casing	Wood	C	Intact	Ivory	Kitchen	11	Negative	< LOD
92	Door	Metal	C	Intact	Ivory	Kitchen	11	Negative	< LOD
93	Cabinet	Wood	D	Intact	Varnish	Kitchen	11	Negative	< LOD
94	Window Casing	Wood	B	Intact	Ivory	Kitchen	11	Negative	< LOD
95	Window Sash	Metal	B	Intact	White	Kitchen	11	Negative	< LOD
96	Jamb	Wood	A	Intact	Ivory	Mechanical	11	Negative	< LOD
97	Door	Wood	A	Intact	Ivory	Mechanical	11	Negative	< LOD
98	Wall	Gypsum	A	Intact	Ivory	Mechanical	11	Negative	< LOD
99	Wall	Gypsum	B	Intact	Ivory	Mechanical	11	Negative	< LOD
100	Wall	Gypsum	C	Intact	Ivory	Mechanical	11	Negative	< LOD
101	Wall	Gypsum	D	Intact	Ivory	Mechanical	11	Negative	< LOD
102	Ceiling	Gypsum		Intact	Ivory	Mechanical	11	Negative	< LOD
103	Support	Wood	D	Intact	Ivory	Mechanical	11	Negative	< LOD
104	Jamb	Wood	C	Intact	Ivory	Mechanical	11	Negative	< LOD
105	Door	Wood	C	Intact	White	Mechanical	11	Negative	< LOD
106	Wall	Gypsum	A	Intact	Ivory	Bedroom	11	Negative	< LOD
107	Wall	Gypsum	B	Intact	Ivory	Bedroom	11	Negative	< LOD
108	Wall	Gypsum	C	Intact	Ivory	Bedroom	11	Negative	< LOD
109	Wall	Gypsum	D	Intact	Ivory	Bedroom	11	Negative	< LOD
110	Ceiling	Gypsum		Intact	Ivory	Bedroom	11	Negative	< LOD
111	Window Sill	Wood	A	Intact	Ivory	Bedroom	11	Negative	< LOD
112	Window Sash	Metal	A	Intact	White	Bedroom	11	Negative	< LOD
113	Door Stop	Wood	C	Intact	Ivory	Bedroom	11	Positive	1
114	Door	Metal	C	Intact	Ivory	Bedroom	11	Negative	< LOD
115	Shelf	Metal	C	Intact	Ivory	Bedroom	11	Negative	< LOD
116	Jamb	Wood	C	Intact	Ivory	Bedroom	11	Negative	< LOD
117	Door	Wood	C	Intact	Varnish	Bedroom	11	Negative	< LOD
118	Wall	Gypsum	A	Intact	Ivory	Bedroom	11	Negative	< LOD
119	Wall	Gypsum	B	Intact	Ivory	Bedroom	11	Negative	< LOD
120	Wall	Gypsum	C	Intact	Ivory	Bedroom	11	Negative	< LOD
121	Wall	Gypsum	D	Intact	Ivory	Bedroom	11	Negative	< LOD
122	Ceiling	Gypsum		Intact	Ivory	Bedroom	11	Negative	< LOD
123	Window Casing	Wood	A	Intact	Ivory	Bedroom	11	Negative	< LOD
124	Window Sash	Metal	A	Intact	Ivory	Bedroom	11	Negative	< LOD

LOD = LIMIT OF DETECTION

PIKE COUNTY HOUSING AUTHORITY
PERRY

Reading #	Component	Substrate	Side	Condition	Color	Room	Unit #	Results	PbC
125	Door Stop	Wood	C	Intact	Ivory	Bedroom	11	Negative	0.6
126	Door	Metal	C	Intact	White	Bedroom	11	Negative	< LOD
127	Shelf	Metal	C	Intact	Ivory	Bedroom	11	Negative	< LOD
128	Jamb	Wood	A	Intact	Ivory	Bathroom	11	Negative	< LOD
129	Door	Wood	A	Intact	Ivory	Bathroom	11	Negative	< LOD
130	Wall	Gypsum	A	Intact	Ivory	Bathroom	11	Negative	< LOD
131	Wall	Gypsum	B	Intact	Ivory	Bathroom	11	Negative	< LOD
132	Wall	Gypsum	C	Intact	Ivory	Bathroom	11	Negative	< LOD
133	Wall	Gypsum	D	Intact	Ivory	Bathroom	11	Negative	< LOD
134	Ceiling	Gypsum		Intact	Ivory	Bathroom	11	Negative	< LOD
135	Chair Rail	Wood	A	Intact	Ivory	Bathroom	11	Negative	< LOD
136	Wall	Gypsum	A	Intact	Ivory	Bedroom	11	Negative	< LOD
137	Wall	Gypsum	B	Intact	Ivory	Bedroom	11	Negative	< LOD
138	Wall	Gypsum	C	Intact	Ivory	Bedroom	11	Negative	< LOD
139	Wall	Gypsum	D	Intact	Ivory	Bedroom	11	Negative	< LOD
140	Ceiling	Gypsum		Intact	Ivory	Bedroom	11	Negative	< LOD
141	Window Casing	Wood	C	Intact	Ivory	Bedroom	11	Negative	< LOD
142	Window Sash	Metal	C	Intact	Ivory	Bedroom	11	Negative	< LOD
143	Door Stop	Wood	A	Intact	Ivory	Bedroom	11	Negative	0.6
144	Door	Metal	A	Intact	White	Bedroom	11	Negative	< LOD
145	Shelf	Metal	A	Intact	Ivory	Bedroom	11	Negative	< LOD
146	Door	Wood	B	Intact	Varnish	Bedroom	11	Negative	< LOD
147	Door Casing	Wood	B	Intact	Ivory	Bedroom	11	Negative	< LOD
148	Wall	Gypsum	A	Intact	Ivory	Living Room	12	Negative	< LOD
149	Wall	Gypsum	B	Intact	Ivory	Living Room	12	Negative	< LOD
150	Wall	Gypsum	C	Intact	Ivory	Living Room	12	Negative	< LOD
151	Wall	Gypsum	D	Intact	Ivory	Living Room	12	Negative	< LOD
152	Ceiling	Gypsum		Intact	Ivory	Living Room	12	Negative	< LOD
153	Jamb	Wood	A	Intact	Ivory	Living Room	12	Negative	< LOD
154	Door	Metal	A	Intact	White	Living Room	12	Negative	< LOD
155	Door Stop	Wood	B	Intact	Ivory	Living Room	12	Negative	0.8
156	Door	Metal	B	Intact	White	Living Room	12	Negative	< LOD
157	Shelf	Metal	B	Intact	Ivory	Living Room	12	Negative	< LOD
158	Door Stop	Wood	B	Intact	Ivory	Living Room	12	Positive	1.3
159	Parting bead	Wood	D	Intact	Ivory	Living Room	12	Negative	0.7
160	Window Sash	Metal	D	Intact	Ivory	Living Room	12	Negative	< LOD
161	Wall	Wood	C	Intact	Ivory	Living Room	12	Negative	< LOD
162	Wall	Gypsum	A	Intact	Ivory	Kitchen	12	Negative	< LOD
163	Wall	Gypsum	B	Intact	Ivory	Kitchen	12	Negative	< LOD
164	Wall	Gypsum	C	Intact	Ivory	Kitchen	12	Negative	< LOD
165	Wall	Gypsum	D	Intact	Ivory	Kitchen	12	Negative	< LOD

LOD = LIMIT OF DETECTION

PIKE COUNTY HOUSING AUTHORITY
PERRY

Reading #	Component	Substrate	Side	Condition	Color	Room	Unit #	Results	PbC
166	Ceiling	Gypsum		Intact	Ivory	Kitchen	12	Negative	< LOD
167	Door Casing	Wood	C	Intact	Ivory	Kitchen	12	Negative	< LOD
168	Door	Metal	C	Intact	Ivory	Kitchen	12	Negative	< LOD
169	Window Sill	Wood	D	Intact	Ivory	Kitchen	12	Negative	< LOD
170	Window Sash	Metal	D	Intact	Ivory	Kitchen	12	Negative	< LOD
171	Cabinet	Wood	B	Intact	Varnish	Kitchen	12	Negative	< LOD
172	Jamb	Wood	C	Intact	Ivory	Kitchen	12	Negative	< LOD
173	Door	Wood	C	Intact	Ivory	Kitchen	12	Negative	< LOD
174	Wall	Gypsum	A	Intact	Ivory	Bedroom	12	Negative	< LOD
175	Wall	Gypsum	B	Intact	Ivory	Bedroom	12	Negative	< LOD
176	Wall	Gypsum	C	Intact	Ivory	Bedroom	12	Negative	< LOD
177	Wall	Gypsum	D	Intact	Ivory	Bedroom	12	Negative	< LOD
178	Ceiling	Gypsum		Intact	Ivory	Bedroom	12	Negative	< LOD
179	Window Casing	Wood	A	Intact	Ivory	Bedroom	12	Negative	0.5
180	Window Sash	Metal	A	Intact	Ivory	Bedroom	12	Negative	< LOD
181	Door Stop	Wood	D	Intact	Ivory	Bedroom	12	Negative	0.5
182	Door	Metal	D	Intact	Ivory	Bedroom	12	Negative	< LOD
183	Shelf	Metal	D	Intact	Ivory	Bedroom	12	Negative	< LOD
184	Jamb	Wood	D	Intact	Ivory	Mechanical	12	Negative	< LOD
185	Door	Wood	D	Intact	Varnish	Mechanical	12	Negative	< LOD
186	Wall	Gypsum	A	Intact	Ivory	Mechanical	12	Negative	< LOD
187	Wall	Gypsum	B	Intact	Ivory	Mechanical	12	Negative	< LOD
188	Wall	Gypsum	C	Intact	Ivory	Mechanical	12	Negative	< LOD
189	Wall	Gypsum	D	Intact	Ivory	Mechanical	12	Negative	< LOD
190	Ceiling	Gypsum		Intact	Ivory	Mechanical	12	Negative	< LOD
191	Shelf	Metal	A	Intact	Ivory	Mechanical	12	Negative	< LOD
192	Door Casing	Wood	D	Intact	Ivory	Mechanical	12	Negative	< LOD
193	Door	Wood	D	Intact	Varnish	Mechanical	12	Negative	< LOD
194	Wall	Gypsum	A	Intact	Ivory	Bedroom	12	Negative	< LOD
195	Wall	Gypsum	B	Intact	Ivory	Bedroom	12	Negative	< LOD
196	Wall	Gypsum	C	Intact	Ivory	Bedroom	12	Negative	< LOD
197	Wall	Gypsum	D	Intact	Ivory	Bedroom	12	Negative	< LOD
198	Ceiling	Gypsum		Intact	Ivory	Bedroom	12	Negative	< LOD
199	Door Stop	Wood	A	Intact	Ivory	Bedroom	12	Negative	0.5
200	Door	Metal	A	Intact	White	Bedroom	12	Negative	< LOD
201	Shelf	Metal	A	Intact	Ivory	Bedroom	12	Negative	< LOD
202	Jamb	Wood	A	Intact	Ivory	Bedroom	12	Negative	< LOD
203	Door	Wood	A	Intact	Varnish	Bedroom	12	Negative	< LOD
204	Wall	Gypsum	A	Intact	Ivory	Bathroom	12	Negative	< LOD
205	Wall	Gypsum	B	Intact	Ivory	Bathroom	12	Negative	< LOD
206	Wall	Gypsum	C	Intact	Ivory	Bathroom	12	Negative	< LOD

LOD = LIMIT OF DETECTION

PIKE COUNTY HOUSING AUTHORITY
PERRY

Reading #	Component	Substrate	Side	Condition	Color	Room	Unit #	Results	PbC
207	Wall	Gypsum	D	Intact	Ivory	Bathroom	12	Negative	< LOD
208	Ceiling	Gypsum		Intact	Ivory	Bathroom	12	Negative	< LOD
209	Chair Rail	Wood	D	Intact	Ivory	Bathroom	12	Negative	< LOD
210	Trim	Wood	D	Intact	White	Exterior	F	Negative	< LOD
211	Soffet	Metal	A	Intact	White	Exterior	F	Negative	< LOD
212	Facia	Metal	A	Intact	White	Exterior	F	Negative	< LOD
213	Gutter	Metal	A	Intact	White	Exterior	F	Negative	< LOD
214	Trim	Metal	D	Intact	White	Exterior	F	Positive	1
242	Calibrate								1
243	Calibrate								1.1
244	Calibrate								1

LOD = LIMIT OF DETECTION

SECTION 4

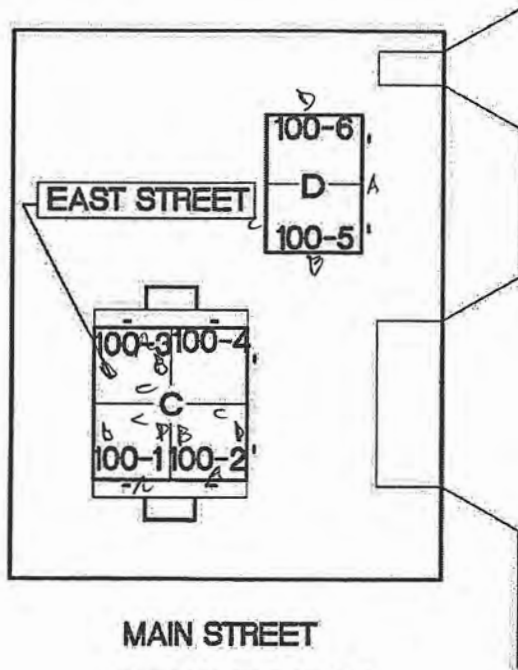

MAIN STREET
SITE 'A' ELDERLY

KEY SITE PLAN

NOT TO SCALE

IL-71-5/PERRY



Handwritten initials/signature

Project No.: 1059	Project Title: KEY SITE PLANS	EGGEMEYER ASSOCIATES ARCHITECTS Westown Centre P.O. Box 1447 Carbondale, IL 62903 IDPR 184-000255 T 618.549.3361 F 618.549.3363 eggemeyer-architects.com	Sheet:
Date: JAN 2012	Projects: IL-71-1, IL-71-2, IL-71-3, IL-71-4, IL-71-5, IL-71-6, IL-71-9, IL-71-10, IL-71-13, IL-71-14 & IL-71-15		C-7
Drawn: MSM	For The: PIKE COUNTY HOUSING AUTHORITY		of 15
Checked: MBD			

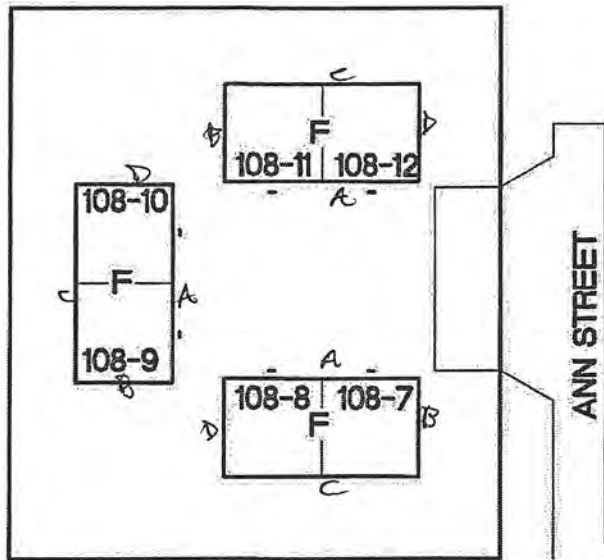

SITE 'B' FAMILY

KEY SITE PLAN

NOT TO SCALE

IL-71-5/PERRY



Handwritten note: 2/2/12

Project No.: 1059	Project Title: KEY SITE PLANS	 EGGEMEYER ASSOCIATES ARCHITECTS Westtown Centre P.O. Box 1447 Carbondale, IL 62903 IDPR 184-000255 T 618.549.3361 F 618.549.3363 eggemeyer-architects.com	Sheet:
Date: JAN 2012	Projects: IL-71-1, IL-71-2, IL-71-3, IL-71-4, IL-71-5, IL-71-6, IL-71-9, IL-71-10, IL-71-13, IL-71-14 & IL-71-15		C-8
Drawn: MSM	For The: PIKE COUNTY HOUSING AUTHORITY		of 15
Checked: MBD			

SECTION 5

Illinois Department of
**PUBLIC
HEALTH**

**LEAD RISK
ASSESSOR LICENSE**

LEAD ID	ISSUED	EXPIRES
001417	1/31/2013	1/31/2014

Darrin Hinds
2975 Stanton St
Springfield, IL 62703



ILLINOIS LEAD PROGRAM
Environmental Health

Alteration of this license shall result in legal action
RISK ASSESSOR CERTIFICATE EXPIRES
8/23/2013

This license issued under authority of the State
of Illinois -Department of Public Health

This license is valid only when accompanied by
a valid training course certificate

If found return to 525 W. Jefferson St Springfield, IL 62761

HINDS ENVIRONMENTAL, INC.

Certifies that *Darrin Hinds*

has completed the requisite training for lead accreditation under USEPA entitled:
**LEAD RISK ASSESSOR REFRESHER
TRAINING COURSE**

in accordance with 40 CFR Part 745
and successfully passed the exam with a score of 70% or above.

Course Date(s): August 26, 2010

Exam Date: August 26, 2010

Expiration Date: August 26, 2013

Certificate Number: RAR/0044

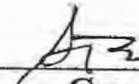

Course Instructor, Steve Honn

Accredited by the Illinois Department of Public Health
2975 Stanton Street Springfield, Illinois 62703-4345 (217) 585-8970

NITON[®] corporation

Certificate of Achievement

This is to certify that

Darrin Hinds

Hinds Environmental Inc.

*has successfully completed the Manufacturer's Training Course
for the **NITON XL** Spectrum Analyzer*

*The one-day course covered radiation safety and monitoring,
L x-ray measurement technology, and
machine maintenance of the **XL** Lead-in-Paint Detector*

V960904-19

Certificate Number

09/4/96-- Springfield, IL

Course Date & Site

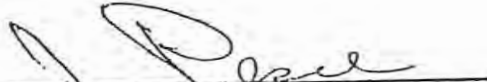

Director of Training



President & CEO - NITON

RESPIRATOR TRAINING AND FIT TEST ACKNOWLEDGEMENT

Hinds Environmental, Inc.'s respirator protection program includes but is not limited to the following components.

I acknowledge that I have received information on use of respiratory protection as contained in the EPA/NIOSH "Guide to Respiratory Protection for the Asbestos Abatement Industry" and OSHA respiratory protection requirements of 1910.134.

I acknowledge that I have participated in hands-on training in the use, limitations, and restrictions of respiratory protection.

I acknowledge that I have received information on the proper cleaning and maintenance of respiratory equipment.

NAME: Darrin Hinds DATE: 5-2-13
HALF FACE RESPIRATORY MANUFACTURER/TYPE: North
HALF FACE MODEL/APPROVAL #: 5500 Series SIZE: Medium
PAPR RESPIRATORY MANUFACTURER/TYPE: MSA
PAPR MODEL/APPROVAL #: Ultra Elite SIZE: Medium
TYPE OF TEST CONDUCTED: QUALITATIVE NEGATIVE PRESSURE
TESTING AGENT USED: IRRITANT SMOKE
TEST CONDUCTED BY: Steven Horn
SIGNATURE OF PERSON BEING FITTED: [Signature]
SIGNATURE OF PERSON CONDUCTING TEST: Steven Horn



**LEAD RISK
ASSESSOR LICENSE**

LEAD ID ISSUED EXPIRES
010116 2/6/2013 1/31/2014

Steven M Honn

5255 Buford St

Springfield, IL 62703



ILLINOIS LEAD PROGRAM
Environmental Health

Alteration of this license shall result in legal action

RISK ASSESSOR CERTIFICATE EXPIRES

11/29/2014

This license issued under authority of the State
of Illinois -Department of Public Health

This license is valid only when accompanied by
a valid training course certificate

If found return to 525 W. Jefferson St Springfield, IL 62761



SAFETY TECHNOLOGIES & SOLUTIONS
"EXCELLENCE IN SAFETY ENGINEERING"

Environmental Health and Occupational Safety Consultants

6520 Manchester Avenue
St. Louis, Missouri 63139
Phone: (314) 644-3323
Fax: (314) 644-3303

Does hereby certify that

Steven Honn

5255 Buford St, Springfield, IL, 62703

*has successfully completed and passed the course examination
with a minimum score of 70 percent for re-accreditation under
Illinois Adm. Code 845, and Missouri 19 CSR 30-70*

Lead Risk Assessor Refresher

Class Date: NOVEMBER 29, 2011
Examination Date: 11/29/2011
Certificate Number: STS20111129-0301LRAR
Certificate Expiration: 11/29/2012
Student SSN: 342-70-3028

Douglas L. Mueller, MS, CSP
Training Manager
STS Safety Technologies & Solutions



Certificate of Achievement

*Steven Honn
Hinds Environmental Inc.*

*Has successfully completed the Manufacturer's Training Course
for the NITON Spectrum Analyzer and is now certified
in radiation safety and monitoring, measurement technology,
and machine maintenance of the NITON XRF Spectrum Analyzer.
(CIH's - The ABIH Awards 1 CM point, approval # 05-396)*

A5110147904

Certificate Number

11/08/05 Davenport, IA

Date & Site of Course



Walter J. Grogan

Training Coordinator

Kenneth R. White

Director of Training



Occupational Training & Supply, Inc.

12601 S. Springfield • Alsip, IL 60803 • 708 / 385-1325

Steven Honn

342-70-3028

has successfully completed the 16 hour Lead Risk Assessor course and has passed the competency exam with a minimum score of 70%. This course is accredited by the Illinois Department of Public Health in accordance with the Illinois Lead Poisoning Prevention Code.

Lead Risk Assessor

Course Date: January 30-31, 2003
Expiration Date: January 31, 2006

Exam Date: January 31, 2003
Certificate: LRA030130336

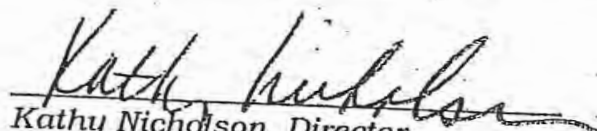
Kathy Nicholson, Director

2003



Safety Support Services, Incorporated

Environmental and Occupational Safety & Health Consultants

1410 S. Jefferson Avenue
St. Louis, Missouri 63104
Phone: (314) 773-4747

Does hereby certify that

Steven M. Honn

3130 Cobblestone Lane Apt. 8, Springfield, IL, 62707

*has successfully completed and passed the course examination
with a minimum score of 70 percent for accreditation under
EPA 40 CFR 745, 77 Illinois Adm. Code 845, and Missouri 19 CSR 30-70*

Lead Inspector Initial

Class Date: November 5-7, 2001
Examination Date: 11/07/2001
Certificate Number: SSS20011107-0292LII
Certificate Expiration: 11/07/2002
Student SSN: 342-70-3028
EPA Expire: 05/07/2002

Douglas L. Mueller, MS, CSP
Certified Safety Professional
OSHA Authorized Instructor



RESPIRATOR TRAINING AND FIT TEST ACKNOWLEDGEMENT

Hinds Environmental, Inc.'s respirator protection program includes but is not limited to the following components.

I acknowledge that I have received information on use of respiratory protection as contained in the EPA/NIOSH "Guide to Respiratory Protection for the Asbestos Abatement Industry" and OSHA respiratory protection requirements of 1910.134.

I acknowledge that I have participated in hands-on training in the use, limitations, and restrictions of respiratory protection.

I acknowledge that I have received information on the proper cleaning and maintenance of respiratory equipment.

NAME: Steven Horn DATE: 5-2-13

HALF FACE RESPIRATORY MANUFACTURER/TYPE: North

HALF FACE MODEL/APPROVAL #: 5500series SIZE: Medium

PAPR RESPIRATORY MANUFACTURER/TYPE: MSA

PAPR MODEL/APPROVAL #: Ultra Elite SIZE: Large

TYPE OF TEST CONDUCTED: QUALITATIVE NEGATIVE PRESSURE

TESTING AGENT USED: IRRITANT SMOKE

TEST CONDUCTED BY: Darrin Hinds

SIGNATURE OF PERSON BEING FITTED: Steven Horn

SIGNATURE OF PERSON CONDUCTING TEST: [Signature]

RE: Annual Medical Information

TO WHOM IT MAY CONCERN:

All Hinds Environmental, Inc. employees who perform project management, air monitoring or building inspection activities have annual medical examinations in accordance with OSHA.

According to the Health Insurance Portability and Accountability Act (HIPAA), medical information is to be kept confidential. This letter serves as documentation that the medical examinations on our employees are current and the complete exam reports are kept in confidential files at Hinds Environmental, Inc., 2975 Stanton Street, Springfield, IL 62703 (217-585-8970).

OFFICIAL USE ONLY - SECURITY RELATED INFORMATION

STATE OF ILLINOIS
 ILLINOIS EMERGENCY MANAGEMENT AGENCY
 DIVISION OF NUCLEAR SAFETY
 1035 OUTER PARK DRIVE
 SPRINGFIELD, ILLINOIS 62704
 (217) 785-9947

RADIOACTIVE MATERIAL LICENSE

Pursuant to the Illinois Radiation Protection Act and the rules and regulations in 32 Illinois Administrative Code promulgated thereunder, and in reliance on statements and representations heretofore made by the licensee, a license is hereby issued authorizing the licensee to receive, acquire, own, possess and transfer radioactive material(s) listed herein; and to use such radioactive material(s) for the purpose(s) and at the place(s) designated below. This license is subject to all applicable rules, regulations and orders of the Agency now or hereafter in effect and to any conditions specified in the license.

<u>LICENSEE</u>	<u>LICENSE NUMBER</u>	<u>EXPIRATION DATE</u>
Hinds Environmental, Inc. 2975 Stanton Street Springfield, IL 62703	IL-01992-01	September 30, 2016
	<u>AMENDMENT NUMBER</u> 7	

Attention: Darrin Hinds
 Radiation Safety Officer

In accordance with letter with attachment dated January 28, 2011, License Number IL-01992-01 is amended in its entirety. Previous amendments are void.

<u>ITEM</u>	<u>RADIONUCLIDE</u>	<u>CHEMICAL and/or PHYSICAL FORM</u>	<u>MAXIMUM ACTIVITY* PER SOURCE</u>	<u>MAXIMUM POSSESSION LIMIT</u>
A.	Cd-109	Sealed Sources - QSA Global, Inc. [formerly AEA Technology (Amersham)] Model CUC.D1 or CUC.P1; Isotope Products Laboratories Model XFB-3.	50 mCi	250 mCi

AUTHORIZED USE:

- A. For use in Thermo Niton Analyzers, LLC XLi Series and XLp Series x-ray fluorescence analyzers for measuring elemental content in various materials.

CONDITIONS

1. Radioactive material shall be used at the licensee's facilities located at 2975 Stanton Street, Springfield, Illinois and at temporary jobsites of the licensee in the State of Illinois in accordance with statements, representations and procedures listed in other conditions of this license.

* μ Ci-microcurie; mCi-millicurie; Ci-Curie; MBq-Megabecquerel; GBq-Gigabecquerel; TBq-Terabecquerel; g-gram; μ g-microgram; kg-kilogram

APPROVED BY: <i>Mary E. Burkhart</i> Mary E. Burkhart, Supervisor of Materials Licensing IL 473-0059	DATE January 31, 2012	PAGE of PAGES 1 3
---	--------------------------	----------------------

OFFICIAL USE ONLY - SECURITY RELATED INFORMATION

STATE OF ILLINOIS
IEMA DIVISION OF NUCLEAR SAFETY
RADIOACTIVE MATERIAL LICENSE

<u>LICENSEE</u>	<u>LICENSE NUMBER</u>	<u>AMENDMENT NUMBER</u>	<u>EXPIRATION DATE</u>
Hinds Environmental, Inc.	IL-01992-01	7	September 30, 2016

2. Radioactive material shall be used by, or under the supervision and in the physical presence of, Darrin Hinds, Steve Homm, or individuals who have successfully completed the manufacturer's training course or an equivalent Agency approved training course. The licensee shall maintain training records of all designated users.
3. The Radiation Safety Officer for this license is Darrin Hinds.
4.
 - A. Each sealed source possessed under this license shall be tested for leakage and/or contamination as specified in 32 Ill. Adm. Code 340.410. Tests for leakage and/or contamination shall be performed by persons specifically licensed to provide such services.
 - B. This license does not authorize analysis of leak test samples. However, the licensee is authorized to collect leak test samples for analysis by persons specifically authorized by the Agency, an Agreement State, or the U.S. Nuclear Regulatory Commission to perform such services.
5. Maintenance, repair and initial radiation monitoring of devices containing radioactive material shall be performed only by persons specifically authorized by the Agency, an Agreement State, or the Nuclear Regulatory Commission to perform such services.
6.
 - A. The source holder shall be locked in the "off" or closed position when the device is not in use.
 - B. Sealed sources shall not be opened or removed from their source holders by the licensee.
7. When performing tests at temporary job sites, the authorized user shall not leave the device unattended. Upon completion of tests, the device shall be locked in the licensee's vehicle or a secure building to prevent unauthorized use, loss, or theft.
8. At any time the licensee is engaged in making measurements by authority of this license at a temporary job site, the licensee shall have a current copy of each of the following documents available at the temporary job site for inspection by the Agency:
 - A. The license, including all active amendments;
 - B. The manufacturer's instruction manual for the sealed sources and devices at the temporary job site;
 - C. The licensee's emergency procedures; and
 - D. The results of the latest test for leakage and/or contamination performed on the sealed source.

* μ Ci-microcurie; mCi-millicurie; Ci-Curie; MBq-Megabecquerel; GBq-Gigabecquerel; TBq-Terabecquerel; g-gram; μ g-microgram; kg-kilogram

APPROVED BY: _____ DATE _____ PAGE of PAGES

Mary E. Burkhardt, Supervisor of Materials Licensing
IL 473-0059

January 31, 2012

2 3

OFFICIAL USE ONLY - SECURITY RELATED INFORMATION

STATE OF ILLINOIS
IEMA DIVISION OF NUCLEAR SAFETY
RADIOACTIVE MATERIAL LICENSE

<u>LICENSEE</u>	<u>LICENSE NUMBER</u>	<u>AMENDMENT NUMBER</u>	<u>EXPIRATION DATE</u>
Hinds Environmental, Inc.	IL-01992-01	7	September 30, 2016

9. Except as specifically provided otherwise by the license, the licensee shall possess and use radioactive material described in all schedules of this license in accordance with statements, representations and procedures contained in, referenced in, or enclosed with the documents listed below. The regulations contained in 32 Ill. Adm. Code: Chapter II, Subchapters b and d shall govern unless the statements, representations and procedures in the licensee's application and correspondence are more restrictive than the regulations. The most recent statements, representations and procedures listed below shall govern if they conflict with previously submitted documents.

A. Applications dated August 14, 2001 and January 28, 2011.

MEB:NLAcjc

* μ Ci-microcurie; mCi-millicurie; Ci-Curie; MBq-Megabecquerel; GBq-Gigabecquerel; TBq-Terabecquerel; g-gram; μ g-microgram; kg-kilogram

APPROVED BY: _____ DATE _____ PAGE of PAGES

Mary E. Burkhardt, Supervisor of Materials Licensing
IL 473-0059

January 31, 2012

3 3